

# 23 BROADWAY

SOUTHEAST CORNER  
OF EAST 23RD STREET AND BROADWAY

「AM  
PS」





# 95 BROADWAY



## Location

Southeast Corner of East 23rd Street & Broadway

**Size** 3,354 SF (GF)

## Frontage

East 23rd Street 85' 8"

Broadway 68' 8"

**Ceiling Height** 19' 7"

**Rent** Upon Request

**Formerly** TD Bank

**Possession** Immediate

## Comments

- Previously TD Bank branch
- Directly facing Madison Square Park
- Next to the entrance of the 23rd Street **R** **W** Subway Station
- Located one block away from both the **6** Subway at 23rd & Park Avenue S. and the **PATH** & **F** **M** Subway at 23rd Street & Sixth Avenue stations

## Co-Tenants

Eataly, Harry Potter, Yeti, Lego, Hoka, Cocodaq  
Valley National Bank, Bank Of America, Lovesac  
Joe & The Juice, Lens Crafters, Chopt, On Running

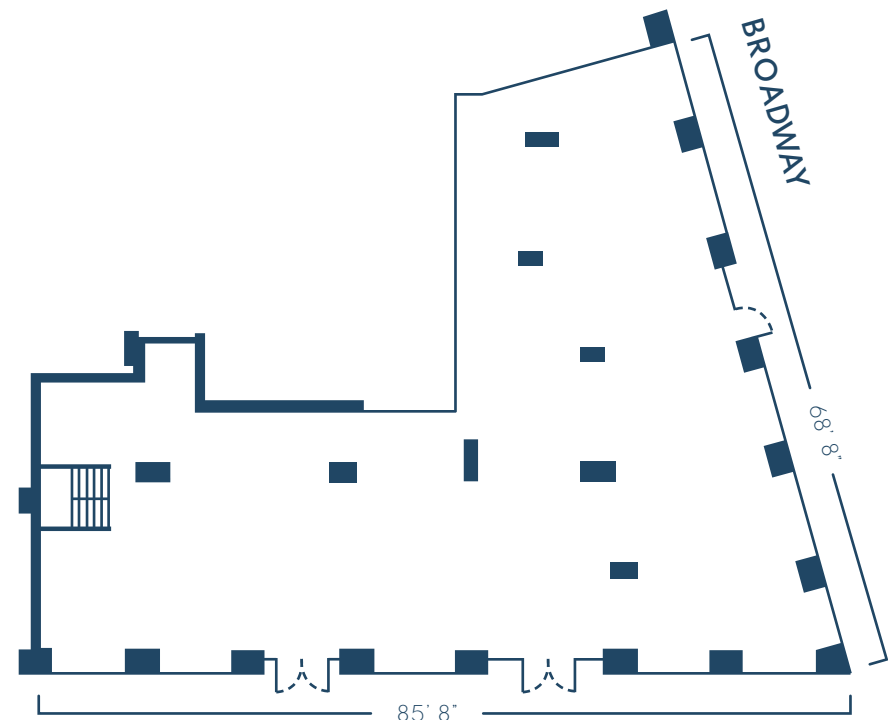

EAST 23RD STREET

# 95 BROADWAY

SOUTHEAST CORNER  
OF EAST 23RD STREET AND BROADWAY

AMPS

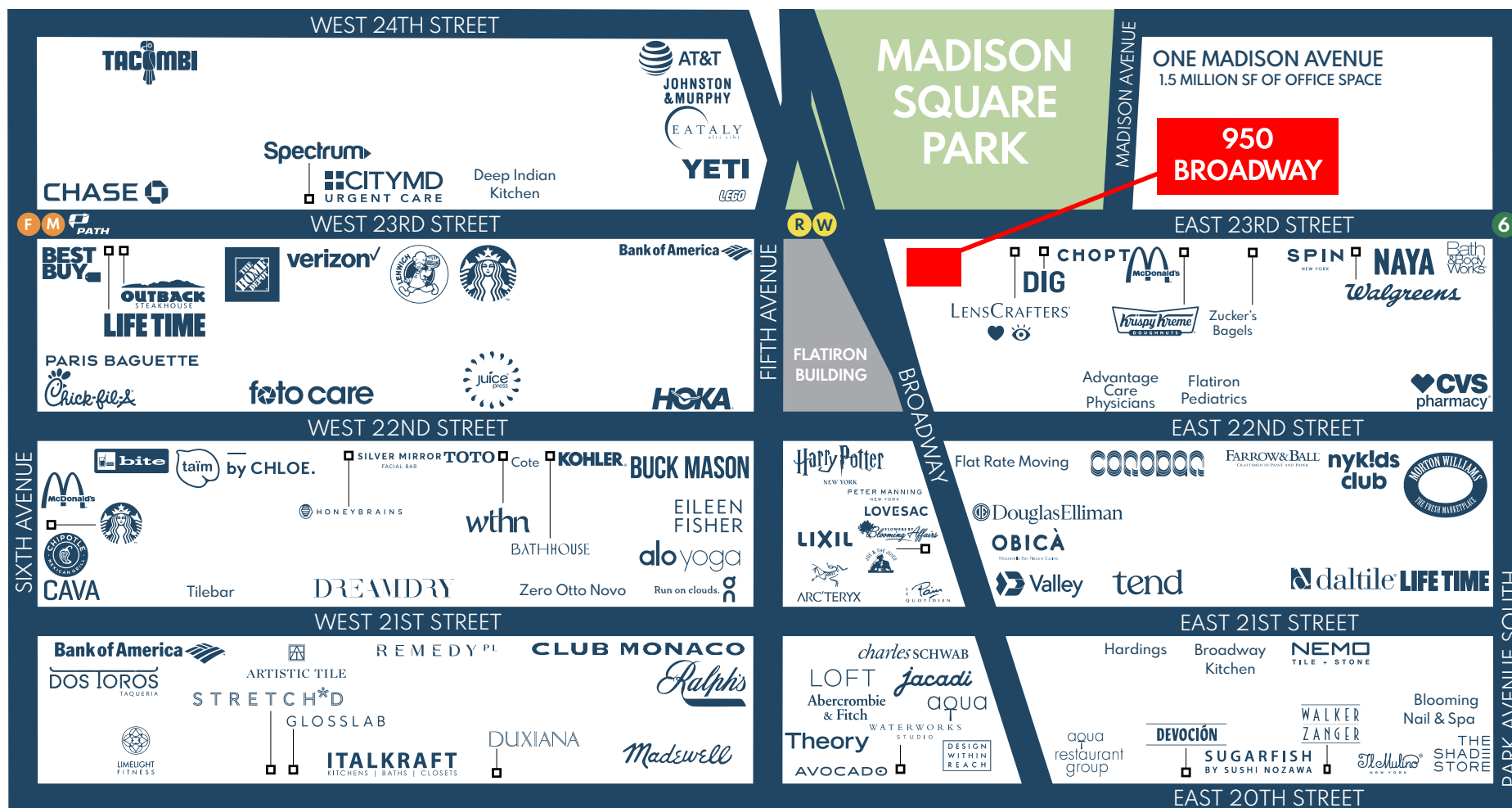



# 9 & BROADWAY

SOUTHEAST CORNER  
OF EAST 23RD STREET AND BROADWAY

AM  
PS







# 95 BROADWAY

— SOUTHEAST CORNER  
OF EAST 23RD STREET AND BROADWAY

「AM  
PS」

**PLEASE CONTACT OUR EXCLUSIVE LEASING AGENTS:**

**CHRISTIAN STANTON**

212.328.8566

[cstanton@ampsre.com](mailto:cstanton@ampsre.com)

**LIBBY MILLER**

212.763.1633

[lmiller@ampsre.com](mailto:lmiller@ampsre.com)